

NOTES:

1. REMOVE WIRE AND NYLON TWINE FROM BALL AND CANOPY.
2. SOAK ROOT BALL AND PLANT PIT IMMEDIATELY AFTER INSTALLATION.
3. STAKING IS REQUIRED FOR ALL TREES IN R.O.W. OR UPON REQUEST OF ARBORIST.
4. REMOVE EXCESS SOIL FROM SITE AND DISPOSE OF IN A LEGAL MANNER.
5. RESEED UNMULCHED, DISTURBED AREAS.

ALL TREES SHALL MEET AMERICAN STANDARD FOR NURSERY STOCK (ANSI Z60.1-2004)

for example

CALIPER	HEIGHT (RANGE)	MAX. HEIGHT	MIN. ROOT BALL DIA.	MIN. ROOT BALL DEPTH
2"	12-14'	16'	24"	16"
3"	14-16'	18'	32"	21"

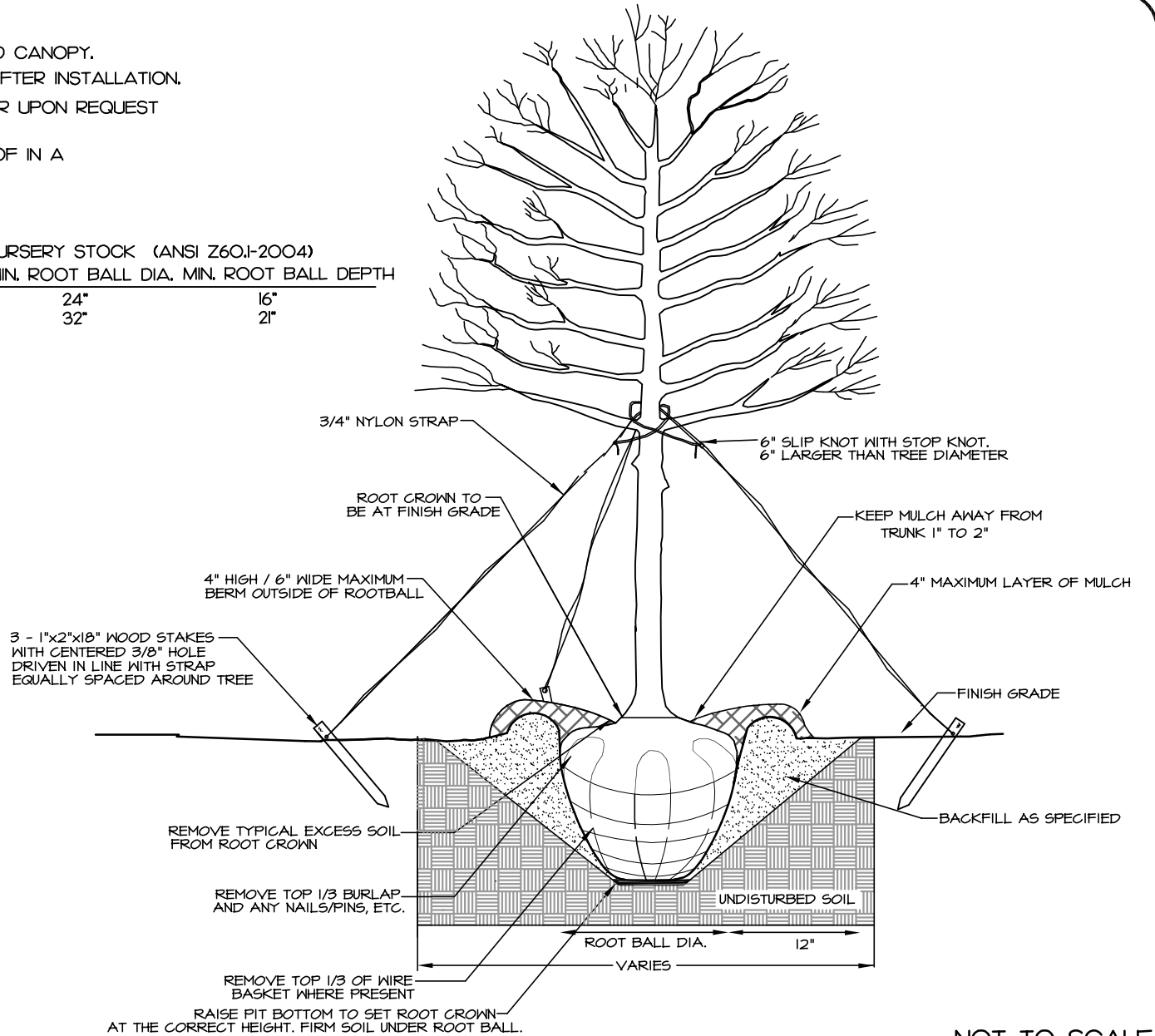

NOT TO SCALE



TOWN OF STALLINGS
LAND DEVELOPMENT STANDARDS

TREE PLANTING
(FOR SINGLE AND MULTI-STEM TREES)

STD. NO.	REV.
40.01	

NOTES:

1. REMOVE ALL BARRIERS UPON COMPLETION OF PROJECT.
2. LANDSCAPING PLANS SHALL SHOW THE LOCATIONS OF ALL TREE PROTECTION FENCES.

SEE APPROVED TREE PRESERVATION PLAN FOR REQUIRED RADIUS OF TREE BARRIER

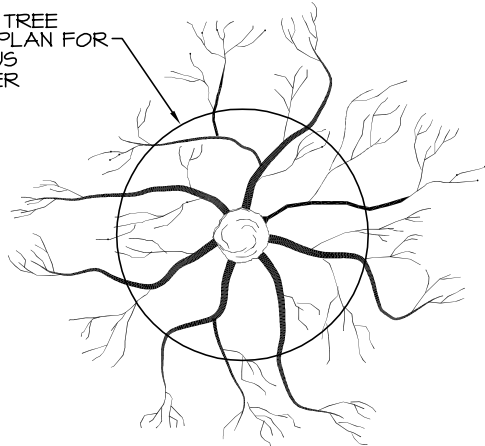

PLAN VIEW OF ROOT ZONE

FOR PRUNING SEE INTERNATIONAL SOCIETY OF ARBORICULTURE SPECS.

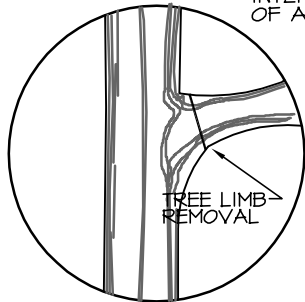

ONE FOOT FOR EACH INCH OF TRUNK DIAMETER OR 1/2 HEIGHT OF TREE WHICHEVER IS GREATER

DEAD TREES AND SCRUB OR UNDER GROWTH SHALL BE CUT FLUSH WITH ADJACENT GRADE. NO GRUBBING ALLOWED UNDER DRIP LINE.

2"x4" STANDARDS + 1"x4" RAILS OR ORANGE SAFETY FENCING MAY BE USED.

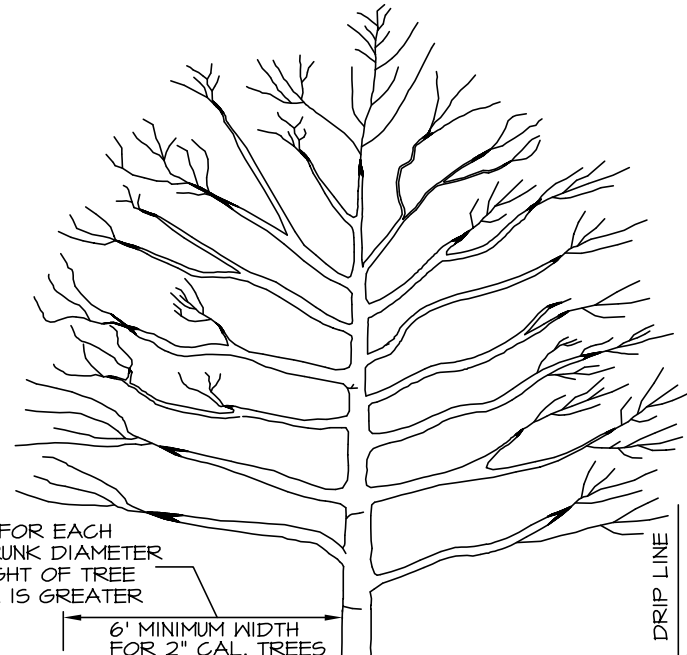

6' MINIMUM WIDTH FOR 2" CAL. TREES OR SMALLER

6" BARK MULCH PLACE BARK MULCH AT AREAS NOT PROTECTED BY BARRIER.

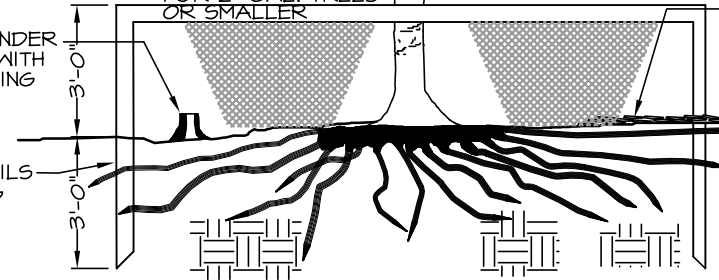

NOT TO SCALE



**TOWN OF STALLINGS
LAND DEVELOPMENT STANDARDS**

TREE PROTECTION DETAIL

STD. NO.	REV.
40.02	

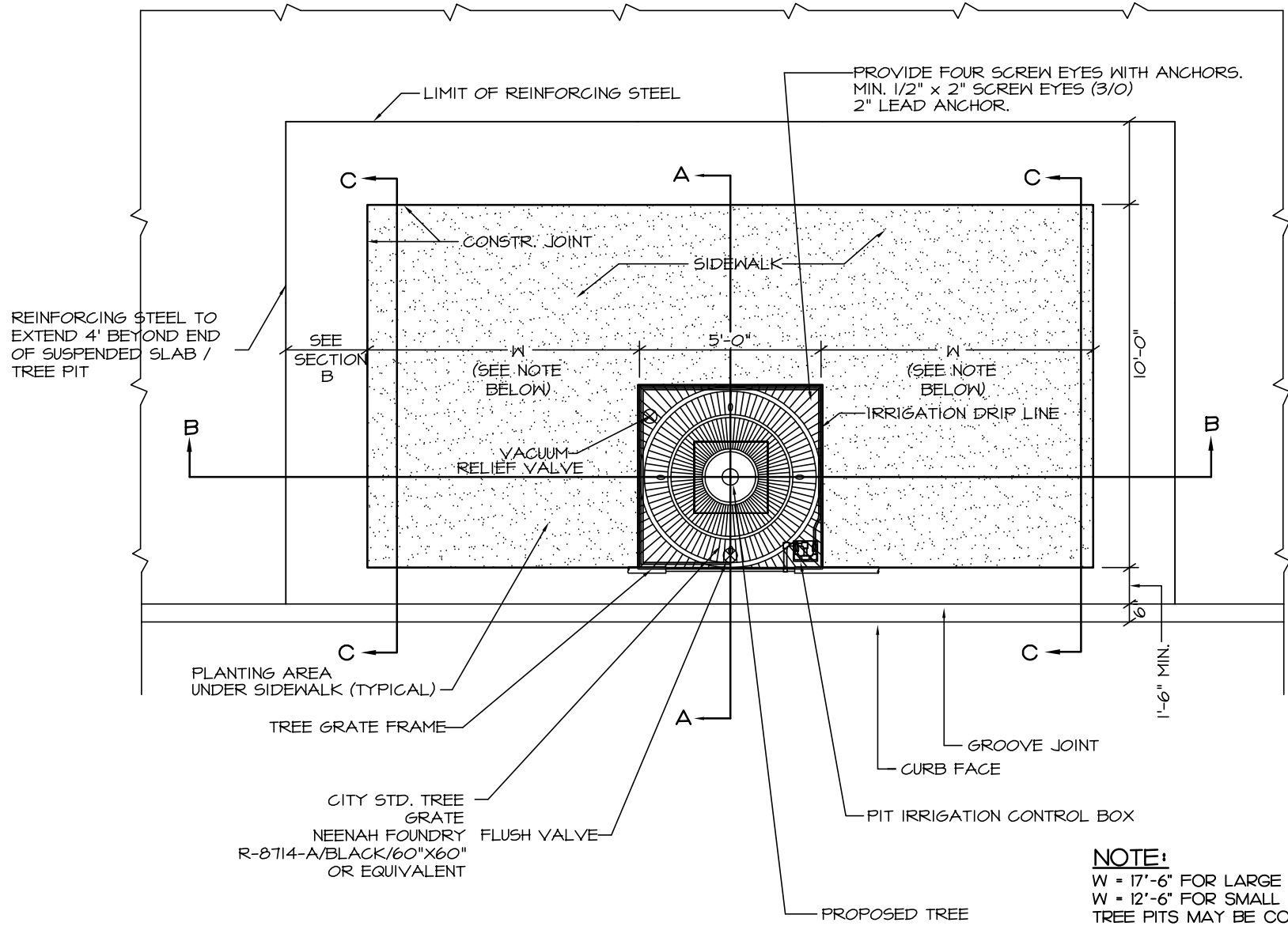

PROVIDE FOUR SCREW EYES WITH ANCHORS.
 MIN. 1/2" x 2" SCREW EYES (3/0)
 2" LEAD ANCHOR.

REINFORCING STEEL TO
 EXTEND 4' BEYOND END
 OF SUSPENDED SLAB /
 TREE PIT

NOTE:
 W = 17'-6" FOR LARGE MATURING TREE.
 W = 12'-6" FOR SMALL MATURING TREE.
 TREE PITS MAY BE CONTIGUOUS

NOT TO SCALE



TOWN OF STALLINGS
LAND DEVELOPMENT STANDARDS

LARGE AND SMALL MATURING TREE PIT
WITH GRATE IN SIDEWALK (PLAN)

STD. NO.	REV.
40.03A	

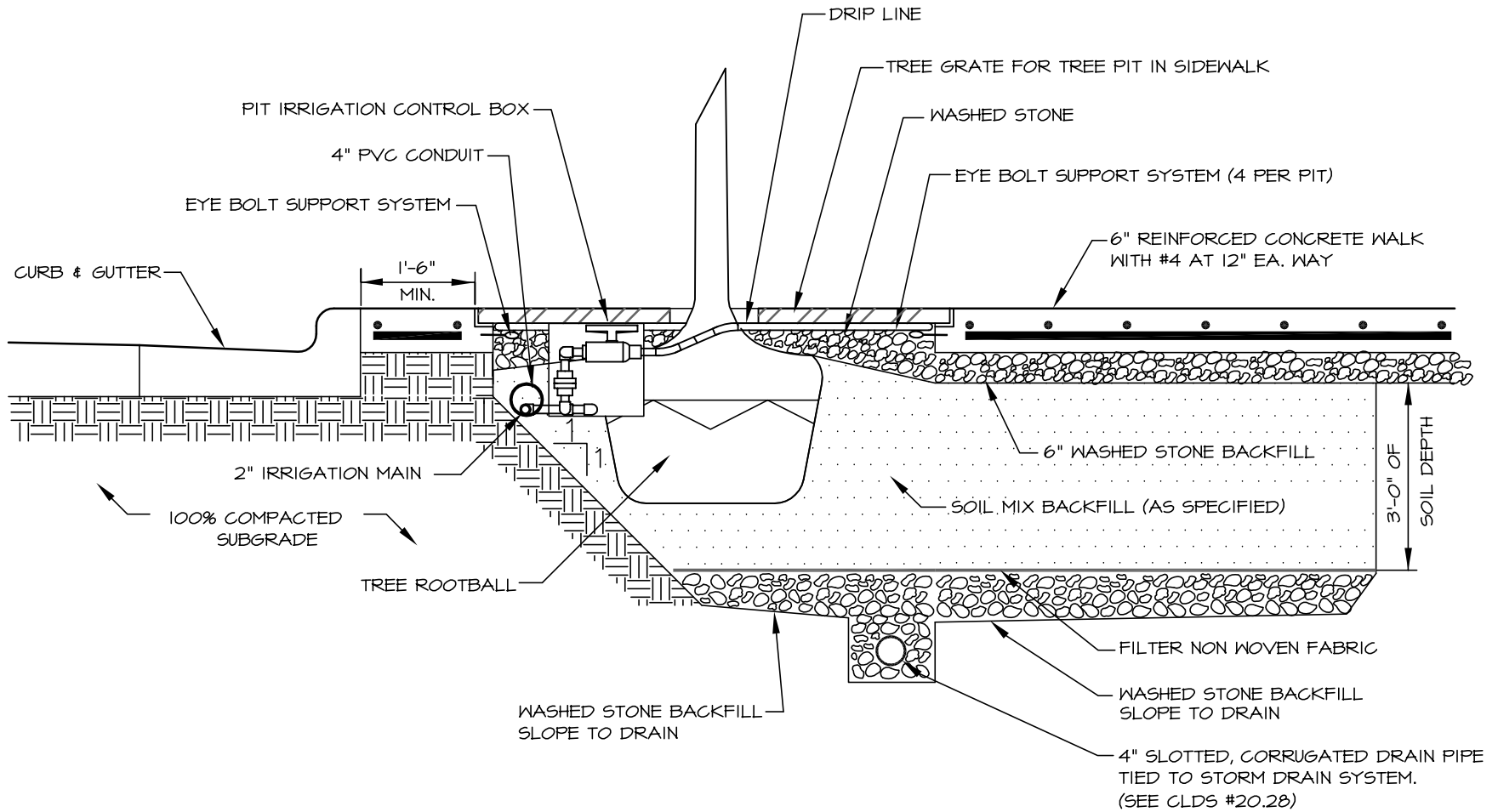

SECTION A

NOT TO SCALE

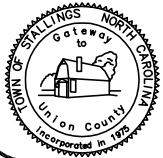

TOWN OF STALLINGS
LAND DEVELOPMENT STANDARDS

**LARGE AND SMALL MATURING TREE PIT
 WITH GRATE IN SIDEWALK (SECTION)**

STD. NO.	REV.
40.03B	

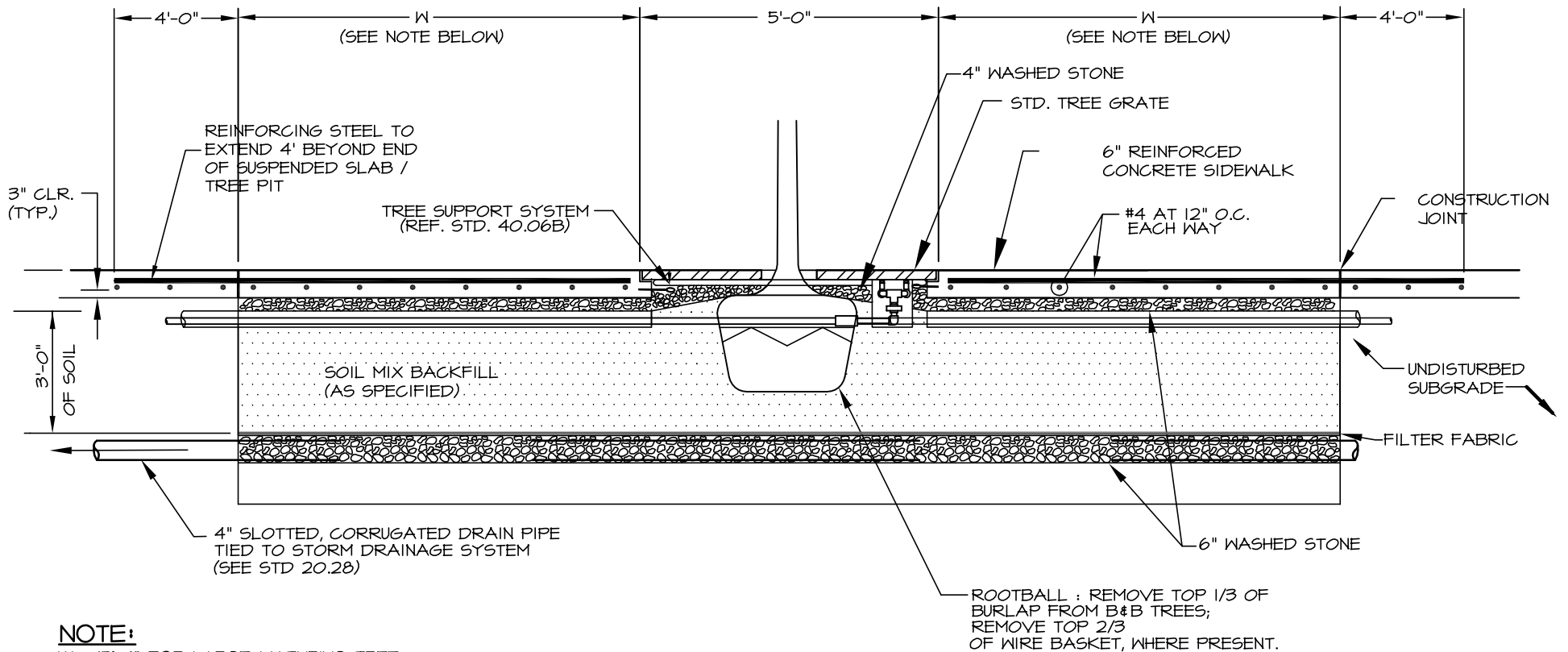

NOTE:

W = 17'-6" FOR LARGE MATURING TREE.
 W = 12'-6" FOR SMALL MATURING TREE.
 TREE PITS MAY BE CONTIGUOUS

SECTION B

NOT TO SCALE



TOWN OF STALLINGS
LAND DEVELOPMENT STANDARDS

**LARGE AND SMALL MATURING TREE PIT
 WITH GRATE IN SIDEWALK (SECTION)**

STD. NO.	REV.
40.03C	

GENERAL NOTES:

1. EXPANSION JOINTS ARE PERMITTED AT 40' MIN. SPACING AND NOT LESS THAN 12'-6" FROM CENTER OF TREE GRATE.
2. SEE STD 10.22 FOR DETAIL OF GROOVE JOINT.
3. CONCRETE SHALL BE 3600 PSI, IN 28 DAYS.
4. ALL REINFORCING STEEL SHALL BE GRADE 60.
5. USE REINFORCED STEEL BAR SUPPORTS IN COMPLIANCE WITH NCDOT STANDARD SPECIFICATION 970-4.

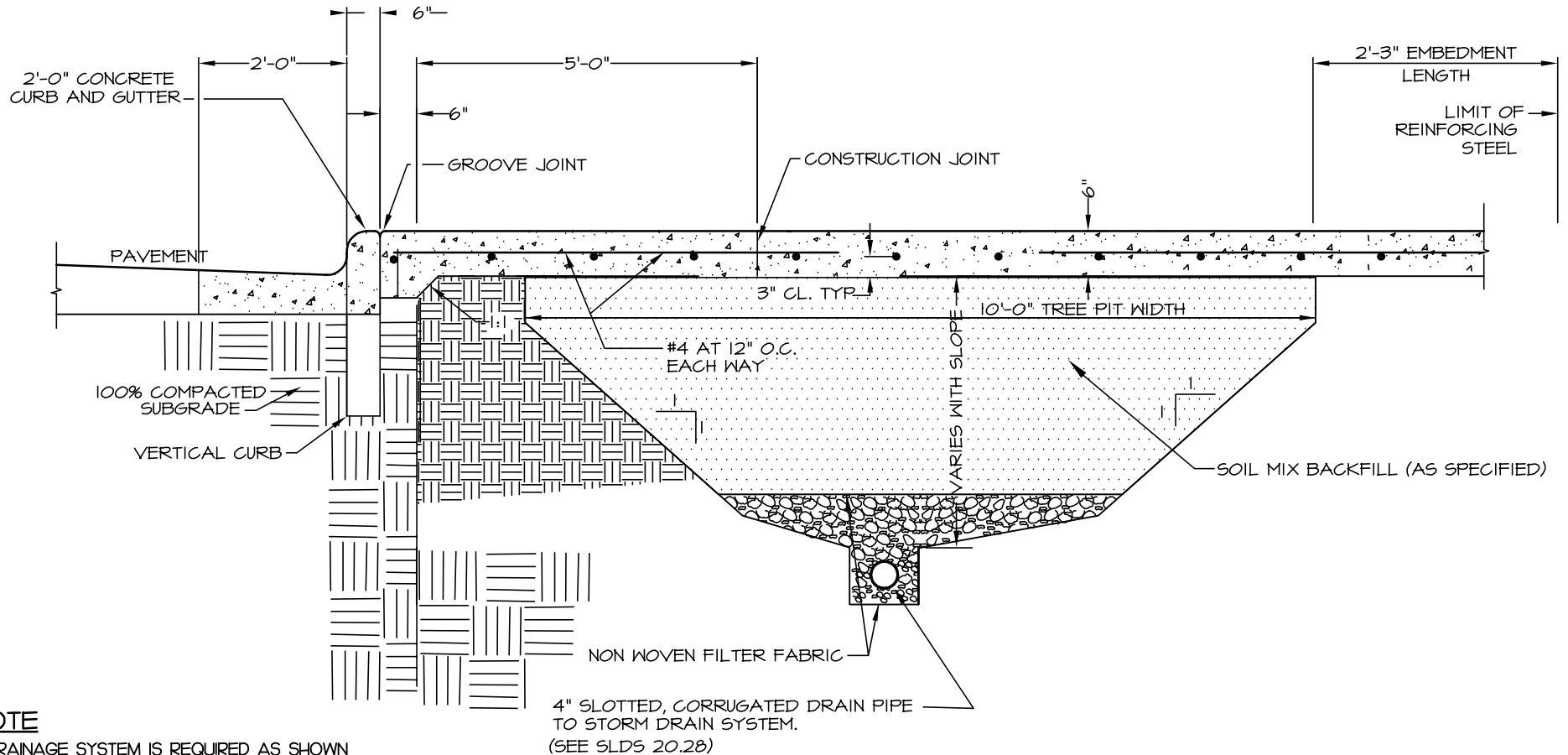

NOTE

A DRAINAGE SYSTEM IS REQUIRED AS SHOWN FOR ALL IRRIGATED PLANTING AREAS LOCATED ADJACENT TO STREET.

SECTION C

NOT TO SCALE



**TOWN OF STALLINGS
LAND DEVELOPMENT STANDARDS**

**LARGE AND SMALL MATURING TREE PIT
WITH GRATE IN SIDEWALK (SECTION)**

STD. NO.	REV.
40.03D	

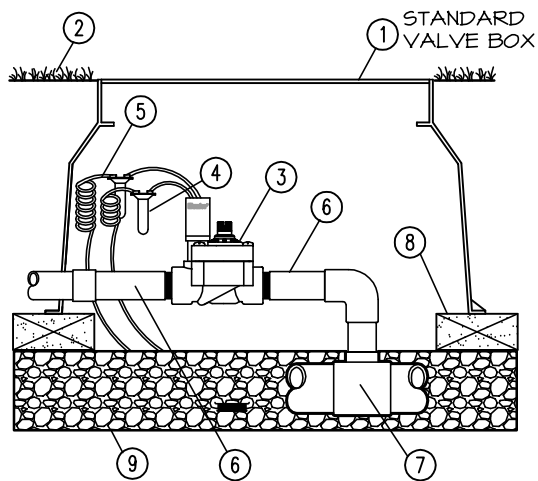

CONTROL VALVE

- ② FINISH GRADE
- ③ CONTROL VALVE WITH FLOW CONTROL
- ④ WATERPROOF CONNECTORS (2)
- ⑤ 18-24" COILED WIRE
- ⑥ SCH 80 T.O.E. NIPPLE
- ⑦ MAIN LINE PIPE & FITTINGS
- ⑧ BRICK SUPPORTS (4)
- ⑨ 3/4" MINUS WASHED GRAVEL, MIN. 3" DEPTH
- ⑩ PRESSURE REGULATOR
- ⑪ FILTER

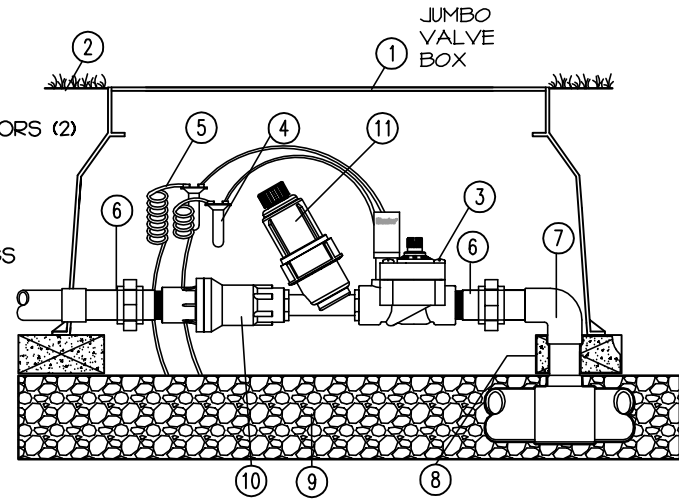

DRIP IRRIGATION W/ PRESSURE REGULATOR AND FILTER

NOT TO SCALE



TOWN OF STALLINGS
LAND DEVELOPMENT STANDARDS

TYPICAL VALVE AND VALVE BOX INSTALLATION

STD. NO.	REV.
40.04	

NOTES:

1. SCARIFY ROOT MASS OF CONTAINERIZED PLANT MATERIAL.
2. INSTALL CONTAINERIZED PLANTS AT FINISHED GRADE
3. TAMP PLANTING MIX FIRMLY AS PIT IS FILLED AROUND EACH PLANT BALL.
4. OMIT COLLAR AROUND EACH SHRUB WHEN IRRIGATION SYSTEM IS PRESENT.
5. SOAK EACH PLANT BALL AND PIT IMMEDIATELY AFTER INSTALLATION.

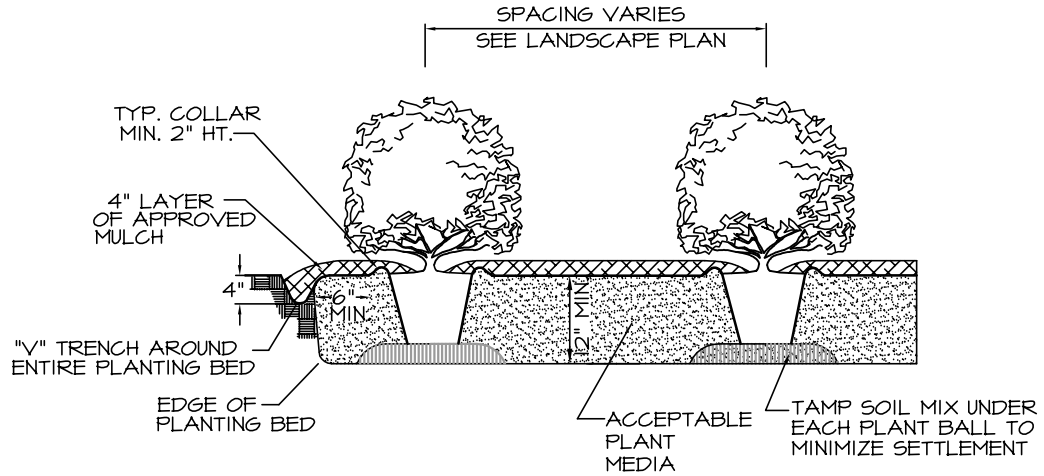

TYPICAL PLANTING BED DETAIL

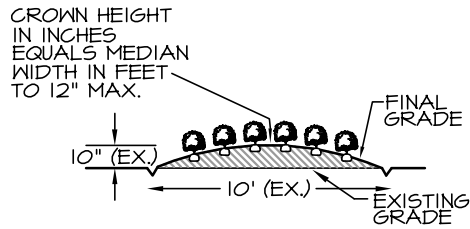

TYPICAL BED CROWNING

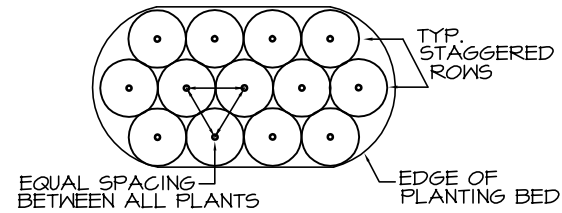

TYPICAL PLANTING BED PLAN

NOT TO SCALE



TOWN OF STALLINGS
LAND DEVELOPMENT STANDARDS

SHRUB PLANTING BED

STD. NO.	REV.
40.05A	

NOTES:

- 1. SCARIFY ROOT MASS OF CONTAINERIZED PLANT MATERIAL.
- 2. INSTALL CONTAINERIZED PLANTS AT FINISHED GRADE
- 3. TAMP PLANTING MIX FIRMLY AS PIT IS FILLED AROUND EACH PLANT BALL.
- 4. OMIT COLLAR AROUND EACH SHRUB WHEN IRRIGATION SYSTEM IS PRESENT.
- 5. SOAK EACH PLANT BALL AND PIT IMMEDIATELY AFTER INSTALLATION.

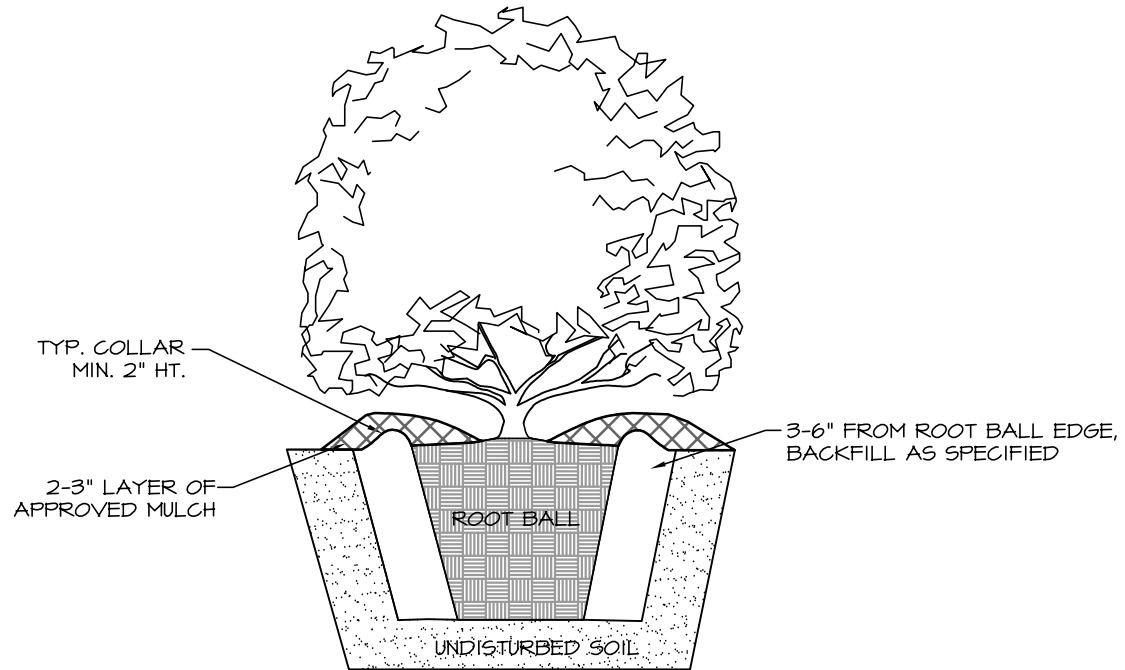

NOT TO SCALE



TOWN OF STALLINGS
LAND DEVELOPMENT STANDARDS

**INDIVIDUAL
SMALL SHRUB/TREE PLANTING**

STD. NO.	REV.
40.05B	

NOTES:

1. FOR NEW PLANTING AREAS, REMOVE ALL PAVEMENT, GRAVEL, SUB-BASE AND CONSTRUCTION DEBRIS BEFORE PREPARING SOIL AND PLANTING TREES.
2. REMOVE SOIL TO A DEPTH OF 18". SCARIFY, TILL OR OTHERWISE LOOSEN THE REMAINING SOIL TO A DEPTH OF 18". ADD NEW PLANTING MIX AS SPECIFIED.
3. SUBSURFACE DRAINAGE SHALL BE INSTALLED IN ALL MEDIANS AND TIED INTO EXISTING STORM DRAIN SYSTEM. A 4 INCH PERFORATED CORRUGATED PVC DRAIN OR HDPE PER AASHTO M252, TYPE CP (SINGLE-WALL, CORRUGATED) SHALL BE INSTALLED IN EACH MEDIAN AT THE BOTTOM OF THE EXCAVATED AREA. DRAIN SHALL BE COVERED WITH A MINIMUM 6 INCHES OF #57 WASHED STONE, THEN WRAPPED WITH A SPECIFIED NON-WOVEN GEOTEXTILE FABRIC. SPECIAL CARE SHALL BE EXERCISED WHEN FILLING MEDIANS WITH SOIL SO NOT TO CRUSH OR DAMAGE THE DRAINAGE SYSTEM.

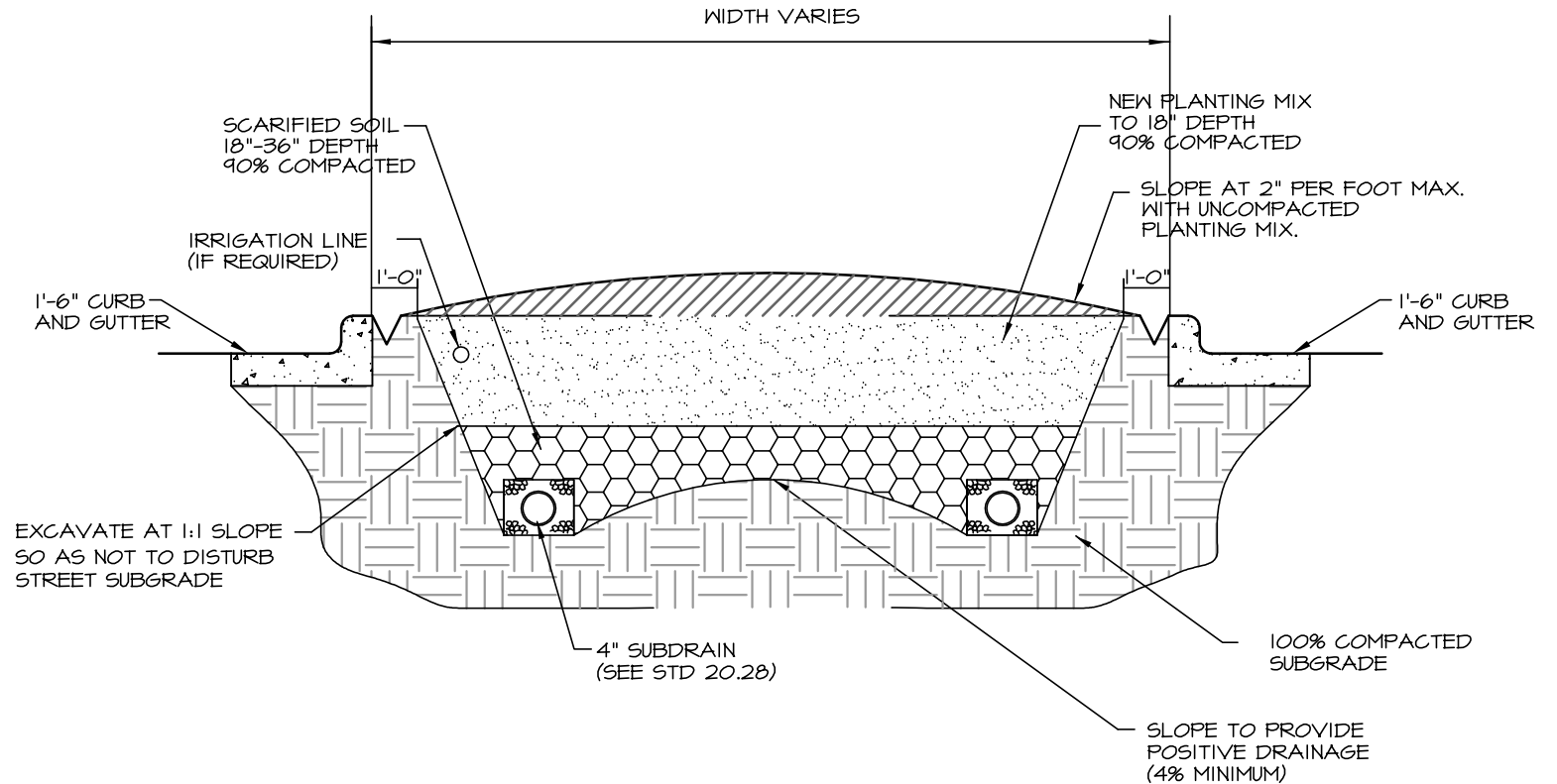

NOT TO SCALE



**TOWN OF STALLINGS
LAND DEVELOPMENT STANDARDS**

**MEDIAN GREATER THAN 120 INCHES
EXCAVATION, DRAINAGE AND BACKFILL**

STD. NO.	REV.
40.08A	

NOTES:

1. FOR NEW PLANTING AREAS, REMOVE ALL PAVEMENT, GRAVEL, SUB-BASE AND CONSTRUCTION DEBRIS BEFORE PREPARING SOIL AND PLANTING TREES.
2. REMOVE SOIL TO A DEPTH OF 18". SCARIFY, TILL OR OTHERWISE LOOSEN THE REMAINING SOIL TO A DEPTH OF 18". ADD NEW PLANTING MIX AS SPECIFIED.
3. SUBSURFACE DRAINAGE SHALL BE INSTALLED IN ALL MEDIANS AND TIED INTO EXISTING STORM DRAIN SYSTEM. A 4 INCH PERFORATED CORRUGATED PVC DRAIN OR HDPE PER AASHTO M252, TYPE CP (SINGLE-WALL, CORRUGATED) SHALL BE INSTALLED IN EACH MEDIAN AT THE BOTTOM OF THE EXCAVATED AREA. DRAIN SHALL BE COVERED WITH A MINIMUM 6 INCHES OF #57 WASHED STONE, THEN WRAPPED WITH A SPECIFIED NON-WOVEN GEOTEXTILE FABRIC. SPECIAL CARE SHALL BE EXERCISED WHEN FILLING MEDIANS WITH SOIL SO NOT TO CRUSH OR DAMAGE THE DRAINAGE SYSTEM.

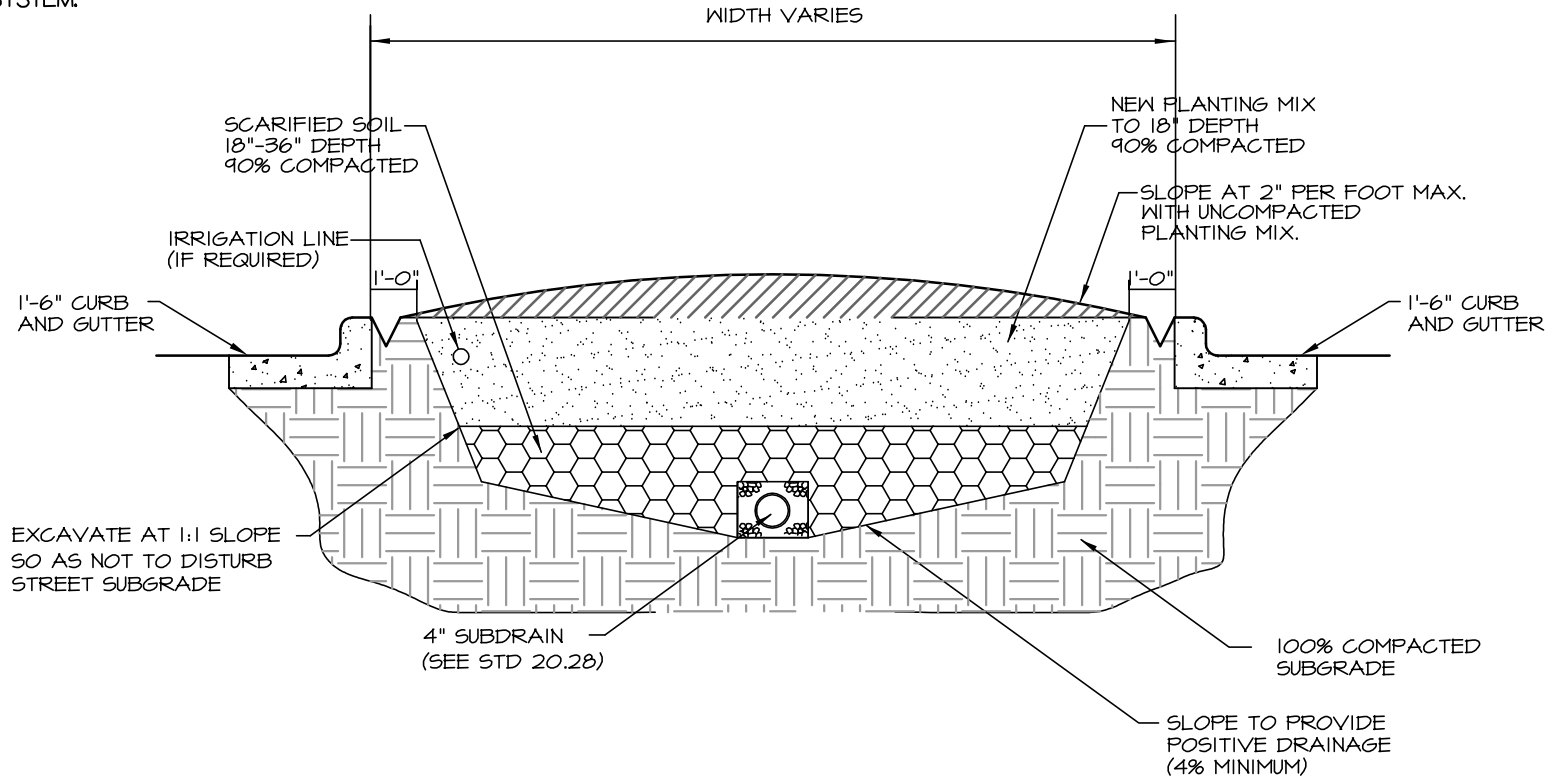

NOT TO SCALE



TOWN OF STALLINGS
LAND DEVELOPMENT STANDARDS

**73 TO 120 INCH MEDIAN
EXCAVATION, DRAINAGE AND BACKFILL**

STD. NO.	REV.
40.08B	

NOTES:

1. FOR NEW PLANTING AREAS, REMOVE ALL PAVEMENT, GRAVEL, SUB-BASE AND CONSTRUCTION DEBRIS BEFORE PREPARING SOIL AND PLANTING TREES.
2. REMOVE SOIL TO A DEPTH OF 18". SCARIFY, TILL OR OTHERWISE LOOSEN THE REMAINING SOIL TO A DEPTH OF 18". ADD NEW PLANTING MIX AS SPECIFIED.
3. SUBSURFACE DRAINAGE SHALL BE INSTALLED IN ALL MEDIANS AND TIED INTO EXISTING STORM DRAIN SYSTEM. A 4 INCH PERFORATED CORRUGATED PVC DRAIN OR HDPE PER AASHTO M252, TYPE CP (SINGLE-WALL, CORRUGATED) SHALL BE INSTALLED IN EACH MEDIAN AT THE BOTTOM OF THE EXCAVATED AREA. DRAIN SHALL BE COVERED WITH A MINIMUM 6 INCHES OF #57 WASHED STONE, THEN WRAPPED WITH A SPECIFIED NON-WOVEN GEOTEXTILE FABRIC. SPECIAL CARE SHALL BE EXERCISED WHEN FILLING MEDIANS WITH SOIL SO NOT TO CRUSH OR DAMAGE THE DRAINAGE SYSTEM.

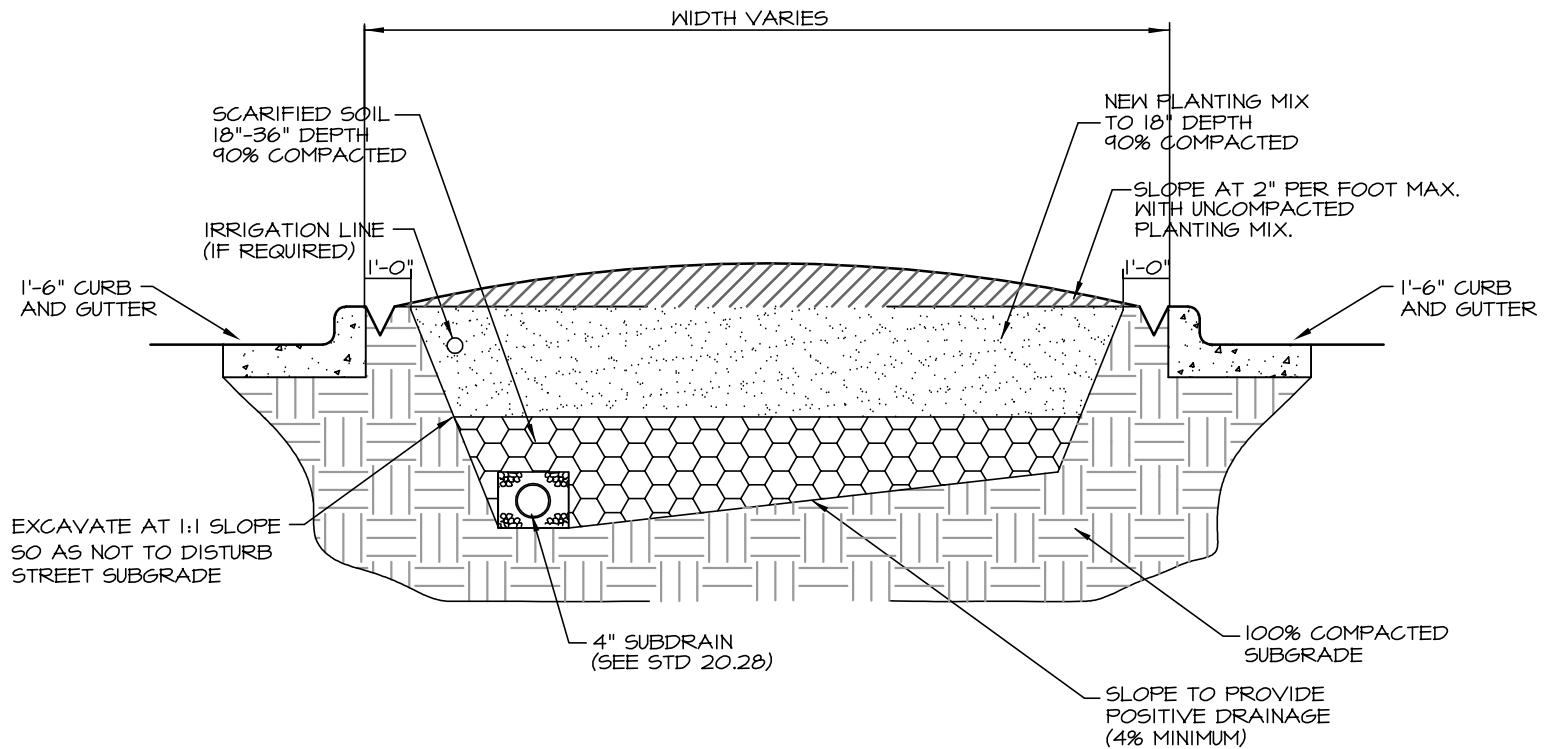

NOT TO SCALE



TOWN OF STALLINGS
LAND DEVELOPMENT STANDARDS

**48 TO 72 INCH MEDIAN
EXCAVATION, DRAINAGE AND BACKFILL**

STD. NO.	REV.
40.08C	

NOTE:

A ROOT FLARE EXCAVATION FOR ALL TREES SPECIFIED WILL BE DONE BY THE TOWN ARBORIST TO ENSURE THAT TREES WERE NOT PLANTED/GROWN TOO DEEPLY AT SOURCE (NURSERY). LANDSCAPE CONTRACTOR SHALL HAVE SUPPLIER MARK GROUND LEVEL LINE ABOVE ROOT BALL. IF TOWN ARBORIST DETERMINES THAT THERE IS EXCESSIVE SOIL OVER THE ROOT CROWN, THESE TREES WILL BE REJECTED.

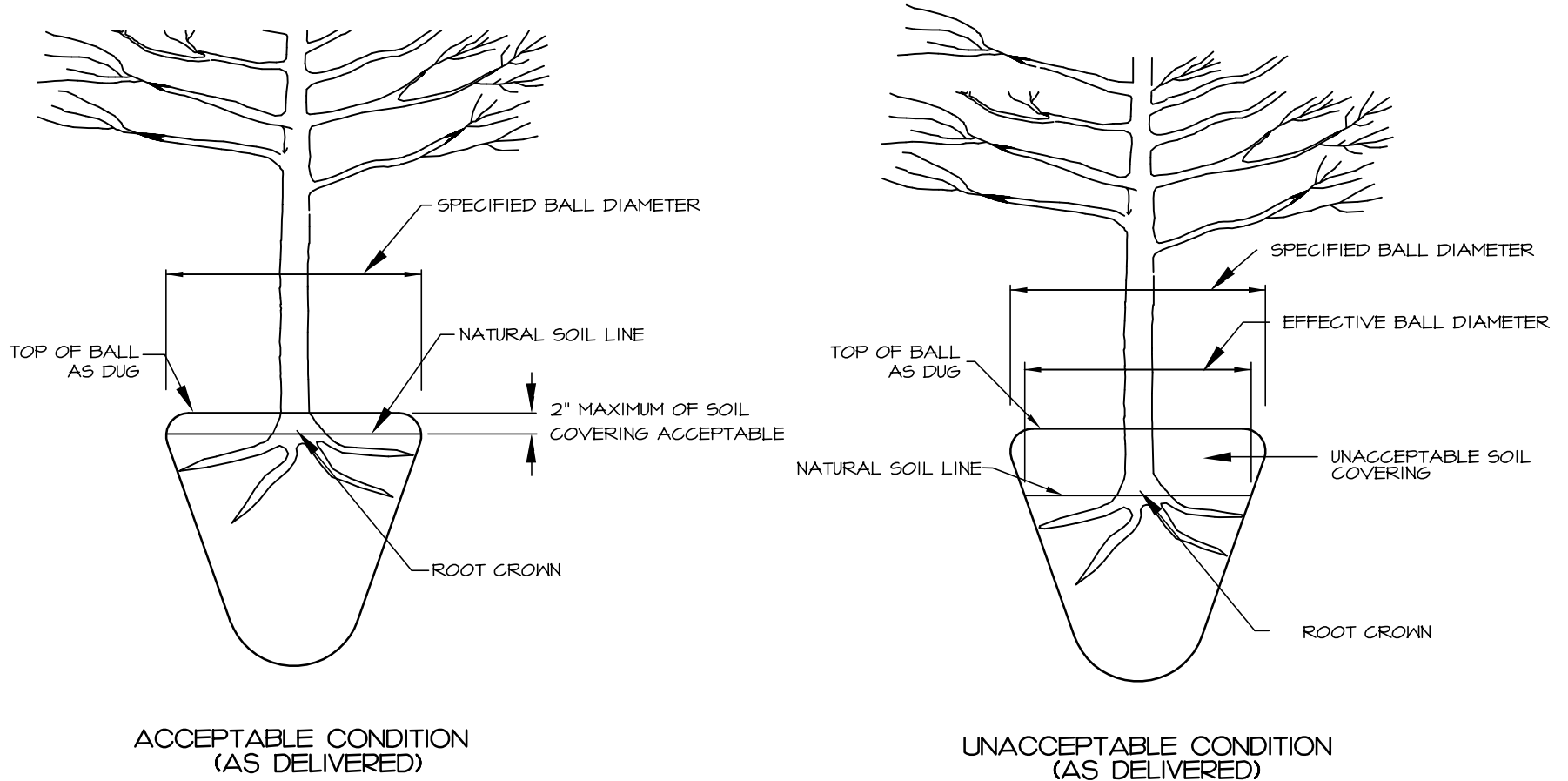

NOT TO SCALE



TOWN OF STALLINGS
LAND DEVELOPMENT STANDARDS

ROOT FLARE DEPTHS
(TREE ROOT BALL CONDITION ON TREES FROM SUPPLIERS)

STD. NO.	REV.
40.09	

PLANTINGS IN STREET RIGHT-OF-WAY

GENERAL NOTES

1. TREE GRATES AND ASSOCIATED IRRIGATION SYSTEMS ARE REQUIRED AT VARIOUS LOCATIONS IN THE UPTOWN AREAS TO COMPLY WITH THE UPTOWN STREETScape GUIDELINES AND OTHER ZONING REQUIREMENTS. ALL OTHER INSTALLATIONS OF IRRIGATION SYSTEMS WITHIN THE RIGHT-OF-WAY OF TOWN OR STATE MAINTAINED STREETS REQUIRE AN ENCROACHMENT AGREEMENT EXECUTED THROUGH THE TOWN OR NCDOT. THE TOWN'S ENCROACHMENT AGREEMENT REVIEW/APPROVAL PROCESS MAY INCLUDE ADDITIONAL REQUIREMENTS. CONTACT THE TOWN OR NCDOT FOR ADDITIONAL INFORMATION REGARDING COST, SUBMITTAL, AND LIABILITY INSURANCE COVERAGE REQUIREMENTS.
2. A DRAINAGE SYSTEM IS REQUIRED AS SHOWN FOR ALL IRRIGATED PLANTING AREAS LOCATED ADJACENT TO STREETS. ALL IRRIGATION/DRAINAGE SYSTEMS NOT REQUIRED BY THE UPTOWN STREET GUIDELINES REQUIRE AN ENCROACHMENT AGREEMENT EXECUTED BY THE TOWN OR NCDOT FOR TOWN OR STATE-MAINTAINED ROADS, RESPECTIVELY. CONTACT THE TOWN OR NCDOT FOR ADDITIONAL INFORMATION REGARDING COST, SUBMITTAL AND LIABILITY INSURANCE COVERAGE REQUIREMENTS.
3. AN INSPECTION SCHEDULE IS NEEDED FOR TREES THAT WILL BE PLANTED IN THE STREET RIGHT OF WAY DUE TO ZONING OR OTHER REQUIREMENTS. LANDSCAPE INSPECTION INCLUDE THE FOLLOWING:

SUBDRAINAGE INSPECTION
TREE PIT/WELL OR PLANTING STRIP INSPECTION
SOIL MIX APPROVALS/INSPECTIONS
TREE APPROVALS/INSPECTIONS - PRIOR TO PURCHASING THE TREES, TO BE MADE BY THE TOWNS REPRESENTATIVE
THIS MAY INCLUDE PHOTO APPROVAL OR PARTICIPATION IN TAGGING THE TREES.
TREE PLANTING INSPECTION
IRRIGATION INSPECTION
FINAL WALK THROUGH

ALL OF THE ABOVE INSPECTIONS WILL BE PERFORMED BY THE TOWN'S REPRESENTATIVE, EXCEPT FOR THE TREE APPROVALS AS NOTED.

NOT TO SCALE



TOWN OF STALLINGS
LAND DEVELOPMENT STANDARDS

TREE PLANTING-NOTES
(DRAINAGE AND INSPECTION)

STD. NO.	REV.
40.10	

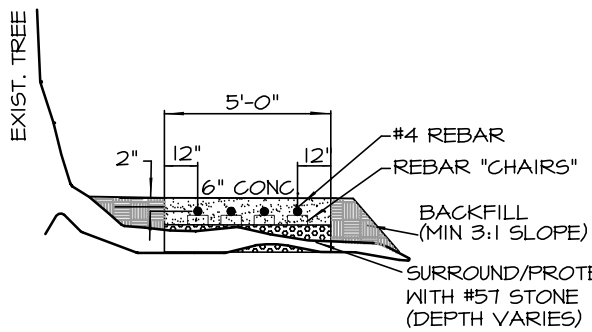
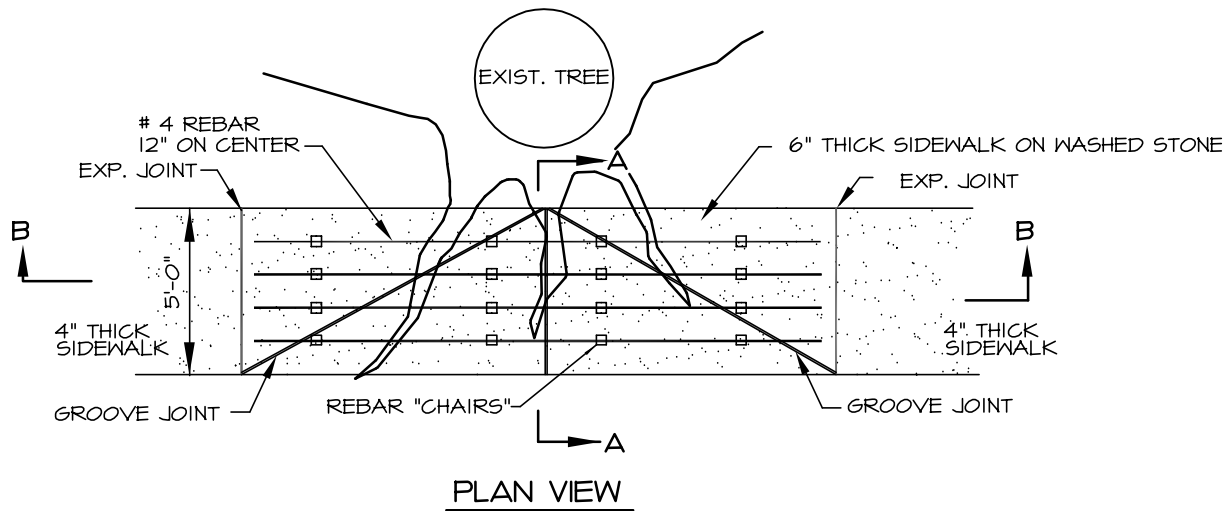

SECTION A-A

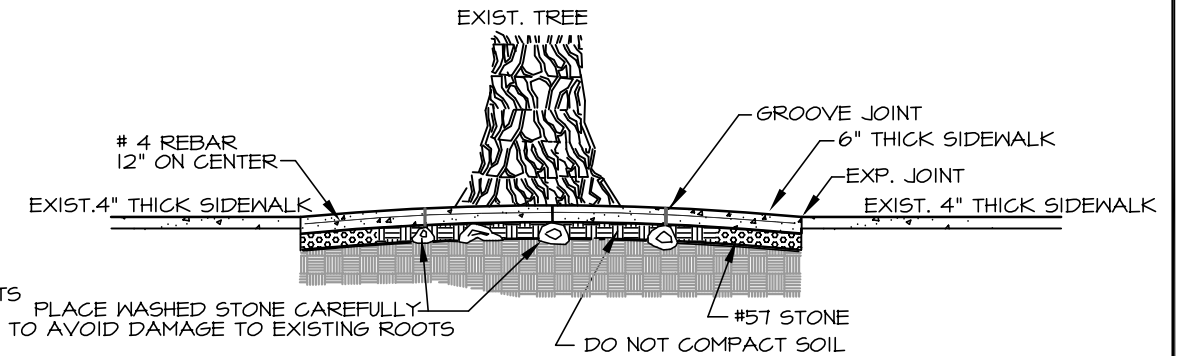

SECTION B-B

NOT TO SCALE



TOWN OF STALLINGS
LAND DEVELOPMENT STANDARDS

BRIDGING TREE ROOTS

STD. NO.	REV.
40.11	

NOTES:

1. THIS TREE BUMPER DETAIL SHALL BE USED WHEN WORKING WITHIN 10' OF AN EXISTING TREE TO BE PROTECTED.
2. ALL TREES SHALL BE SAVED UNLESS NOTED OTHERWISE ON THE PLANS OR DIRECTED BY THE ENGINEER.
3. LUMBER, WIRE, AND SANDBAGS MAY BE REUSED AT OTHER TREES.
4. THE INTENT OF THIS DETAIL IS TO PROTECT EXISTING TREES FROM DAMAGE DURING CONSTRUCTION ESPECIALLY FROM BACKHOE ARM SWING. AN ALTERNATE APPROACH MAY BE USED IF APPROVED IN WRITING BY THE ENGINEER AFTER CONSULTATION WITH THE TOWN'S DULY AUTHORIZED REPRESENTATIVE.

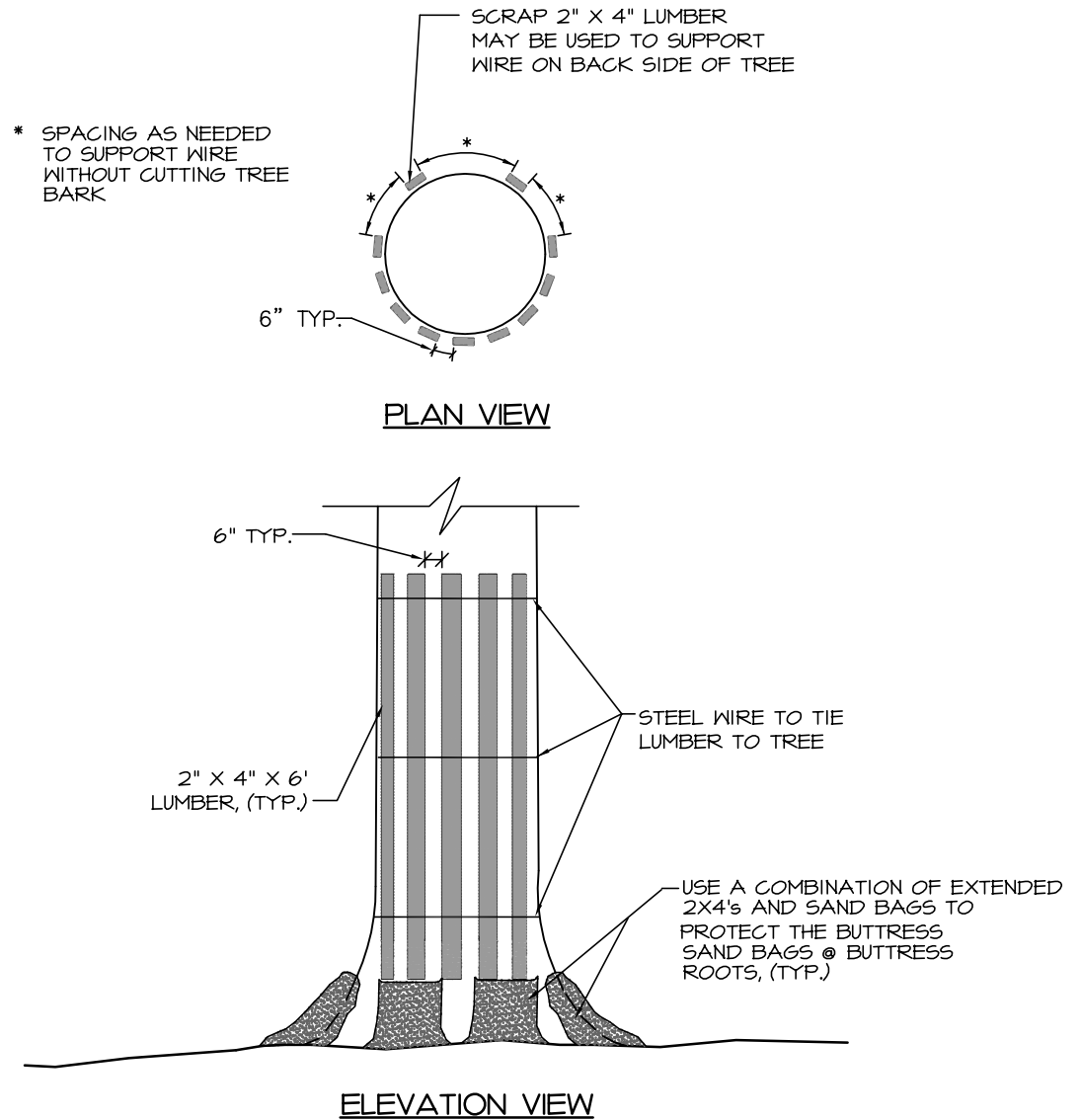

NOT TO SCALE



TOWN OF STALLINGS
LAND DEVELOPMENT STANDARDS

TEMPORARY TREE PROTECTION DETAIL

STD. NO.	REV.
40.12	

NOTES:

1. CONTRACTOR SHALL USE EXTREME CAUTION WHEN WORKING NEAR EXISTING TREES.
2. WHERE EXISTING TREES ARE WITHIN 4' OF THE PROPOSED BACK OF CURB, THE PROPOSED CURB SHALL END A MINIMUM OF 12" FROM THE TREE'S BUTTRESS ROOTS.
3. CONTRACTOR SHALL COORDINATE WITH THE TOWN'S REPRESENTATIVE TO IDENTIFY TREES FOR WHICH THIS DETAIL APPLIES PRIOR TO CONSTRUCTION NEAR THE TREE(S).
4. NO TREES SHALL BE REMOVED UNLESS CLEARLY SPECIFIED ON THE PLANS OR IDENTIFIED BY THE ENGINEER.
5. AVOID FILL PLACEMENT NEAR TREE.
6. FOR ADDITIONAL SPECS., SEE SECTION 1000 PART 03, B AND C

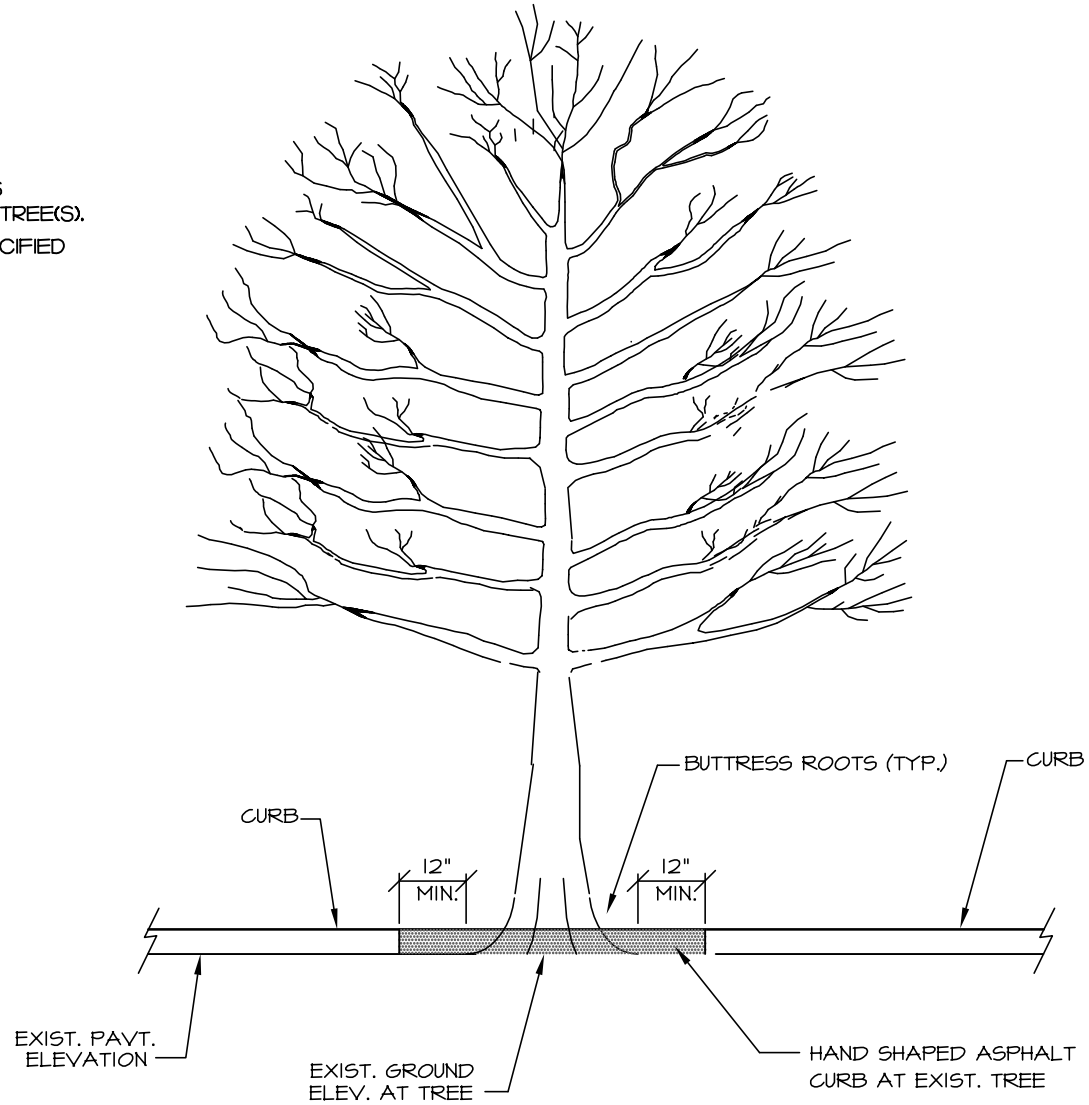

NOT TO SCALE



**TOWN OF STALLINGS
LAND DEVELOPMENT STANDARDS**

**ASPHALT CURB PLACEMENT AT
EXISTING TREES**

STD. NO.	REV.
40.13	

NOTES:

1. APPLICATION DESIGNED FOR TREES NO LESS THAN 12" IN DIAMETER.
2. FILL - SEE CLDSM - PLANTING MIX. APPLY TO A DEPTH OF FOUR (4) INCHES AT BASE OF TREE, TAPER TO GRADE. SEED AND MULCH ACCORDING TO CLDSM.
3. STONE - #5, WASHED. MAINTAIN EXPOSED SIX (6) INCH WIDTH AT TRUNK OF TREE. PLACE TO MINIMUM DEPTH OF TWELVE (12) INCHES AND A MAXIMUM OF TWENTY-FOUR (24) INCHES AT THE BASE OF THE TREE AND TAPER OUTWARD TO NO LESS THAN TEN (10) FEET.
4. FABRIC - NON-WOVEN GEOTEXTILE FABRIC, SUCH AS MIRAFI OR EQUIVALENT, PLACED BETWEEN STONE AND FILL. IT IS NOT TO COVER STONE EXPOSED AT TRUNK OF TREE.

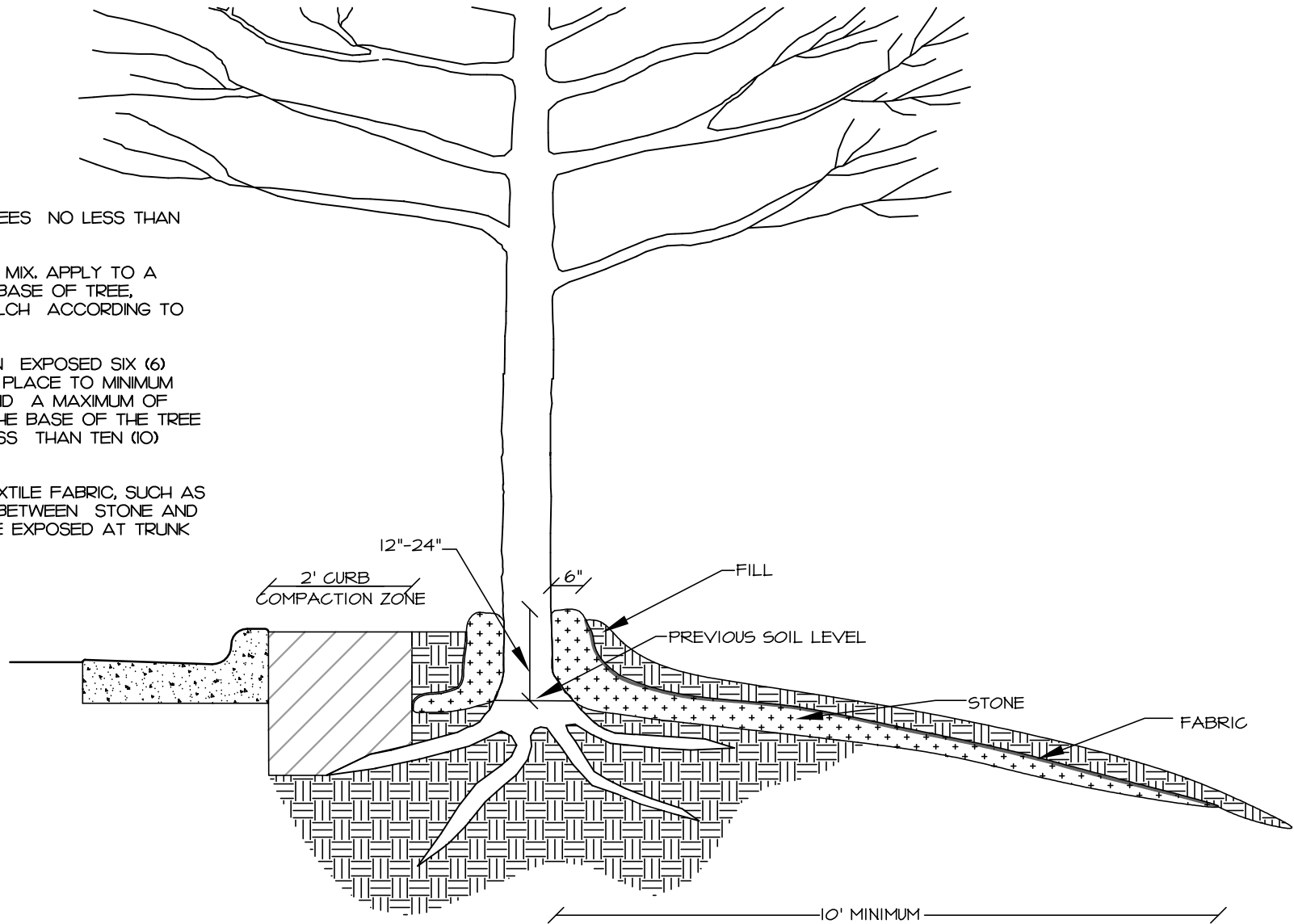

NOT TO SCALE



**TOWN OF STALLINGS
LAND DEVELOPMENT STANDARDS**

ROCK CHIMNEY

STD. NO.	REV.
40.14	